

# DIMENSIONS & DATA CERTIFIED FOR:

Representative:

Order:

Customer:

Order:

Project:

Requirements:

By:

Date:

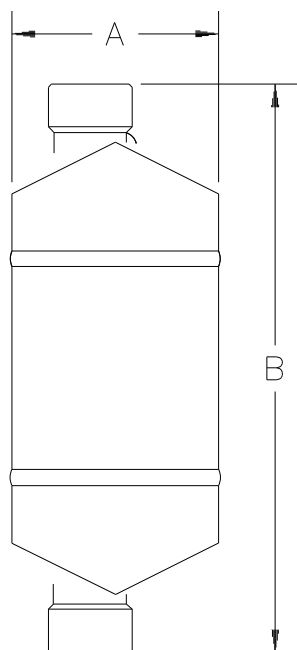

LIST OF MATERIALS	
PART NAME	MATERIAL
Connections	304 Stainless Steel ASTM A479
Body	Carbon Steel ASTM A106 Gr. B Sch. 80 Pipe
Valve Seat	Titanium
Valve	
Valve Retainer	302 Stainless Steel ASTM A167
Lever	20 Cb-3 Stainless Steel
Guide Screw	303 Stainless Steel ASTM A580
Bucket	304 Stainless Steel ASTM A167
Bulkhead	304L Stainless Steel ASTM A167
Feed Tubes	304 Stainless Steel ASTM A312
Cup	18-8 Stainless Steel

### PHYSICAL DATA

Pipe Connections* (NPT, BSPT, SW)	1/2 [DN 15]	3/4 [DN 20]
"A" (Diameter)	4 [102]	
"B" (Height)	11 [279]	
Weight	12 lb [5 kgs]	
Maximum Allowable Pressure (Vessel Design)	1000 psig at 800°F	[69 bar at 427°C]
Maximum Operating Pressure	1000 psi	[69 bar]

Note:

Dimensions are in inches [mm]

\*1/2", 3/4" flanges available upon request



Armstrong International, Inc.  
Three Rivers Division  
Three Rivers, MI 49093

**Armstrong** (269) 273-1415 Fax (269) 278-6555  
Posted on Armstrong's homepage [www.armstrong-intl.com](http://www.armstrong-intl.com)

Product	CD No.	Date
401-SH STEAM TRAP	1011	6/19/06
		Rev. B